

*the journey starts here*



## Coachman Collection 2012



This brochure has been designed to provide you with basic information prior to making a purchase decision. Please refer to your dealer for additional information before you buy.

Coachman Caravan Company Limited reserves the right to alter technical specifications, prices and model ranges as materials and conditions demand and can accept no responsibility for discrepancies between these and subsequent models. Household items illustrated in the brochure (e.g. fruit and personal effects) have been used to enhance photography and are not supplied with the caravan. Limitations in the printing process may mean colours are not truly represented.

It should be noted that distributors and dealers are not the agents of Coachman Caravan Company Limited and therefore are not authorised to bind the Company by any specific or implied undertaking or representation.

Please note: Touring caravans are designated by the model year. The model year runs from the 1st September to the 31st August: for example a 2012 year model would have been despatched by the manufacturer no earlier than the 15th August, 2011.

Please note: the method of calculating the MRO and payload figures has recently changed. Allowances for essential equipment (e.g. gas cylinders) previously allowed for in the user payload are now within the MRO. The provision for a leisure battery has been included within the personal effects payload allowances.

All Coachman models have been certified by the National Caravan Council for compliance with stringent European Standards, British Legislation and industry set Codes of Practice, specifically relating to health and safety issues. The approval process covers the testing and inspection of critical areas of the product from fire safety, weights and dimensions to gas, electrics and ventilation. Every Coachman caravan carries the "NCC Approved Caravan" badge. The NCC also conducts unannounced inspections at the Coachman factory to ensure continued compliance.

NCC Approval gives you peace of mind that your caravan is legal and safe.

The tow cars used in this brochure are for illustration purposes only.

As the owner of a Coachman caravan, you will be automatically entitled to join our Owners' Club. For more information about the Club, please contact: The Membership Officer, Coachman Owners' Club, 49 Regency Gardens, Yardley Wood, Birmingham, B14 4JS or visit their website: [www.coachmanclub.co.uk](http://www.coachmanclub.co.uk)

Photography: [www.markkensett.com](http://www.markkensett.com)



Designed and produced by: [www.bluestormdesign.co.uk](http://www.bluestormdesign.co.uk)

*the journey starts here*





It is over a quarter of a century since the first Coachman caravan was hand-crafted in Hull. Caravanning has changed a lot since then, but we continue to build all our caravans with the same care and attention, whilst improving our models every year.

For 2012, our award-winning Amaras have been improved, and our Pastiche, VIP and Laser ranges have been revolutionised. Thousands of man-hours have gone into creating what we believe to be our best ever caravans.

We started by taking advanced new materials that had never been used in the creation of UK tourers, to make every model in the new range stronger and lighter than ever before.

We then redefined the shape of the Pastiche, VIP and Laser, modernising and streamlining the design to include large panoramic windows and bigger doors, which make the caravans some of the brightest and most spacious that you can buy.

Finally, we added innovative new features, like mood lighting and a Truma Combi Boiler, to ensure that our caravans are warmer and cosier than they have ever been.

Simply put, our 2012 range of caravans are the best we have ever produced. Whether you are an experienced tourer or a first-time buyer, there is a 2012 Coachman to suit your needs.

Our priority is producing caravans that provide great value. We know that buying a caravan is a big investment, and that customers want to be certain that it will stand the test of time.

We use superior materials as standard, and every Coachman is built to ensure that it continues to function perfectly and look fabulous after many years of faithful service.

If you are looking for a new caravan, the journey starts here...

LASER	
4-9	
VIP	
10-15	
PASTICHE	
16-21	
AMARA	
22-27	

*the journey starts here*







### *Laser – Simply the best*

For those who demand the absolute best...

The all-new Laser features everything a discerning caravanner could want. With stunning interior design, sumptuous soft furnishings and spacious washrooms, the two models in the 2012 Laser range provide the best possible base for your next holiday.

The 640/4 provides the ultimate in comfort and convenience, with a fixed double bed layout, and the 655/6 boasts two sitting areas, with space for the whole family. If you want to experience the next level in luxury caravanning, look no further than the Laser.







### 2012 Laser features and benefits:

A brand new sleek, stylish shape, contemporary walnut interior design, and increased storage space are just some of the new features of the 2012 Laser.

An Alde wet central heating system, mood lighting and the largest panoramic window currently available on a UK tourer combine to make the Laser the last word in luxury touring.







### External Features

- Grade 3 thermal insulation
- **NEW** one-piece aluminium sides with **NEW** exterior graphics
- **NEW** wheel spats and skirts incorporating side marker lights
- AL-KO Secure wheel clamping system (2)
- AL-KO jack
- Shock absorbers
- Vortex graphite shadow alloy wheels (steel spare wheel)
- Mud flaps
- **NEW** stand-on hitch cover
- **NEW** style AKS stabiliser
- Completely **NEW** automotive style shell with an exterior width of 7' 7"
- **NEW** acrylic capped ABS front with panoramic roof window, three opening front windows and gas bottle locker door with gas strut
- **NEW** full height acrylic capped ABS rear panel with high level LED brake light and light cluster incorporating twin reversing lights
- Laminated roof
- 45mm thick floor with Styrofoam core for insulation and strength
- LED awning light incorporating rain gutter
- **NEW** double sealed one-piece exterior door with waste bucket
- **NEW** full length door flyscreen
- Lined external locker with 230 volt socket (not in the 640/4)
- Stabilform heavy duty corner steadies
- **NEW** Polyplastic windows with soft-form pleated blinds (flat blind in the kitchen and bathroom areas)

### Internal Features

- Headroom 6' 5"
- Fully engineered aluminium frame front beds with hinged lift-up system supported by a gas strut in the open position
- Luxurious sprung bedding and backrests finished in fire retardant fabric and a superior sprung mattress in the 640/4
- Luxurious floor covering with luxury loose-lay carpets
- **NEW** contemporary Walnut interior design incorporating bespoke moulded units
- **NEW** furniture doors with double metallic trim and **NEW** door and drawer handles
- **NEW** pull-out top on the 3-drawer chest of drawers
- Metal runners on all drawers
- Domestic style bathroom door in the 640/4
- **NEW** Belfast sink in the 640/4
- **NEW** kitchen workstation with Spinflo Argent recessed stainless steel sink and drainer, glass lid, plastic bowl and food grade chopping board with improved work surface and storage areas
- Cocktail cabinet in both models

### Equipment

- AL-KO ATC system (active trailer control)
- Remote control alarm system with PIR and tilt sensors for added security (Key fob also controls the awning light)
- Phantom satellite tracking system
- Pioneer Entertainment centre with remote control Radio/CD/MP3 player plus DVD video playback to two locations and iPod/MP3 connection
- Thetford Aspire oven with **NEW** dual fuel hob and grill with electronic ignition and flame failure
- Microwave oven in dedicated housing
- Thetford 107 litre refrigerator with 11 litre freezer, electronic ignition, digital display and stylish curved stainless finish door with black trim
- **NEW** Alde wet central heating system
- Water system with combined pressure switch/surge damper, filter and exterior cold shower
- **NEW** underfloor insulated 36 litre water tank
- Electric flush Thetford C260 cassette toilet with pump filler
- **NEW** Omnivent rooflight extractor fan with clear dome
- External BBQ gas point
- Truma gas regulator hose

### Electrical System

- 13 pin Jaeger plug
- **NEW** design easy-access power centre
- BCA dual stage power centre with 20 amp power supply for caravan 12 volt requirements and separate battery conditioning charger
- **NEW** 12 volt digital control panel
- **NEW** direct and indirect LED lighting throughout the whole caravan
- 12 volt LED reading lights
- Floor level courtesy light(s)
- Exterior TV aerial input socket
- Exterior satellite input socket
- **NEW** solar panel connection
- Status 530 swivel directional TV aerial

**LASER**

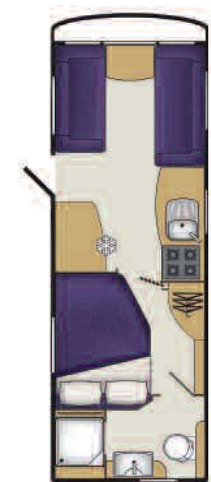

LASER 640/4



LASER 655/6

**PHANTOM**  
the tracking system for caravans & motorhomes





### ***VIP - Stand out from the crowd***

For those who appreciate the finer things in life...

Filled with added features and boasting a striking new shape, the new VIP is guaranteed to turn heads and stand out from the crowd. Quality equipment, high specification and industry-leading craftsmanship come together in the VIP to create a real Coachman classic.

From the stylish, well equipped bathrooms and generous kitchens, to the comfortable and contemporary seating areas, customers who choose the VIP won't be left in any doubt about the quality and value of their investment.





### 2012 VIP features and benefits

Perfect for caravanners who won't compromise, the VIP features a powerful, energy-efficient Truma Combi-boiler that is exclusive to Coachman, a fantastic Pioneer entertainment system, and fully controllable mood lighting throughout.

For added peace of mind, an Al-Ko Secure system is fitted as standard, and with four different models, including two fixed bed layouts to choose from, there is a luxury caravan for everyone in the VIP range.







### External Features

- Grade 3 thermal insulation
- **NEW** one-piece aluminium sides with **NEW** exterior graphics
- **NEW** wheel spats and skirts incorporating side marker lights
- AL-KO Secure wheel clamping system
- AL-KO jack
- Shock absorbers
- Vortex graphite shadow alloy wheels (steel spare wheel)
- Mud flaps
- **NEW** stand-on hitch cover
- **NEW** style AKS stabiliser
- Completely **NEW** automotive style shell with an exterior width of 7' 7"
- **NEW** acrylic capped ABS front with panoramic roof window, three opening front windows and gas bottle locker door with gas strut
- **NEW** full height acrylic capped ABS rear panel with high level LED brake light and light cluster incorporating twin reversing lights
- Laminated roof
- 45mm thick floor with Styrofoam core for insulation and strength
- LED awning light incorporating rain gutter
- **NEW** double sealed one-piece exterior door with waste bucket
- **NEW** full length door flyscreen
- Lined external locker with 230 volt socket (not in the 560/4)
- Stabilform heavy duty corner steadies
- **NEW** Polyplastic windows with soft-form pleated blinds (flat blind in the kitchen and bathroom areas)

### Internal Features

- Headroom 6' 5"
- Fully engineered aluminium frame front beds with hinged lift-up system supported by a gas strut in the open position
- Luxurious sprung bedding and backrests finished in fire retardant fabric and a superior sprung mattress in the 545/4 and the 560/4
- Luxurious floor covering with luxury loose-lay carpets
- **NEW** contemporary walnut interior design incorporating bespoke moulded units
- **NEW** furniture doors with double metallic trim and **NEW** door and drawer handles
- **NEW** pull-out top on the 3-drawer chest of drawers
- Metal runners on all drawers
- Domestic style bathroom door in the 460/2, 520/4 and the 560/4
- **NEW** re-designed end-bathroom with round domestic quality shower cubicles in the 460/2 and the 520/4
- **NEW** Belfast sinks in all end-bathroom models
- **NEW** kitchen workstation with Spinflo Argent recessed stainless steel sink and drainer, glass lid, plastic bowl and food grade chopping board with improved work surface and storage areas
- Cocktail cabinet in all models

### Equipment

- AL-KO ATC system (active trailer control)
- Remote control alarm system with PIR and tilt sensors for added security (Key fob also controls the awning light)
- Pioneer Entertainment centre with remote control Radio/CD/MP3 player plus DVD video playback to two locations and iPod/MP3 connection
- Thetford Aspire oven with **NEW** dual fuel hob and grill with electronic ignition and flame failure
- Microwave oven in dedicated housing
- Thetford 107 litre refrigerator with 11 litre freezer, electronic ignition, digital display and stylish curved stainless finish door with black trim
- **NEW** and **EXCLUSIVE** Truma Combi-boiler with programmable timing system for heating and hot water
- Truma awning warmer
- Truma Ultraflow water system with combined pressure switch/surge damper, filter and exterior cold shower
- Electric flush Thetford C260 cassette toilet with pump filler
- **NEW** Omnivent rooflight extractor fan with clear dome
- External BBQ gas point
- Truma gas regulator hose

### Electrical System

- 13 pin Jaeger plug
- **NEW** design easy-access power centre
- BCA dual stage power centre with 20 amp power supply for caravan 12 volt requirements and separate battery conditioning charger
- **NEW** digital 12 volt control panel
- **NEW** direct and indirect LED lighting throughout the whole caravan
- 12 volt LED reading lights
- Floor level courtesy light(s)
- Exterior TV aerial input socket
- Exterior satellite input socket
- **NEW** solar panel connection
- Status 530 swivel directional TV aerial

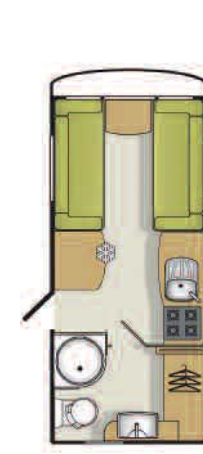

VIP 460/2



VIP 520/4



VIP 545/4

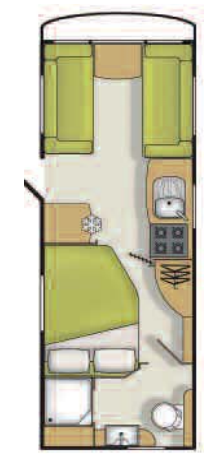

VIP 560/4





 **PASTICHE**

***The Pastiche – Your home away from home***

For those who value quality, comfort and style.

If you're looking for a modern, well equipped, practical and above all, comfortable way to enjoy your leisure time, then look no further. The Pastiche offers 5 different layouts designed to cater for couples and families, so you can be confident there is a model to suit your needs.

With stylish interior design, and quality craftsmanship inside and out, there has never been a better time to invest in a Coachman Pastiche.





### 2012 Pastiche features and benefits:

With a stylish new design both inside and out, beautiful, contemporary ash finish and comfortable, modern soft furnishings, the Pastiche range really stands out from the crowd.

Ergonomically designed to make the best possible use of internal space, the Pastiche comes readily equipped with everything needed for a fantastic holiday.

Built to stand the test of time, and to look beautiful after years of faithful service, the 2012 Pastiche is sure to please the most discerning caravan enthusiast.

**PASTICHE**







### External Features

- Grade 3 thermal insulation
- **NEW** one-piece aluminium sides with **NEW** exterior graphics
- **NEW** wheel spats and skirts incorporating side marker lights
- Provision for the AL-KO Secure wheel clamping system
- Shock absorbers
- Vortex graphite shadow alloy wheels (steel spare wheel)
- **NEW** stand-on hitch cover
- **NEW** style AKS stabiliser
- Completely **NEW** automotive style shell with an exterior width of 7' 7"
- **NEW** acrylic capped ABS front with panoramic roof window, three opening front windows and gas bottle locker door with gas strut
- **NEW** full height acrylic capped ABS rear panel with high level LED brake light and light cluster incorporating twin reversing lights
- Laminated roof
- 45mm thick floor with Styrofoam core for insulation and strength
- LED awning light incorporating rain gutter
- **NEW** double sealed one-piece exterior door with waste bucket
- **NEW** full length door flyscreen
- Lined external locker with 230 volt socket (not in the 560/4)
- Stabilform heavy duty corner steadies
- **NEW** Polyplastic windows with soft-form pleated blinds (flat blind in the kitchen and bathroom areas)

### Internal Features

- Headroom 6' 5"
- Fully engineered aluminium frame front beds with hinged lift-up system supported by a gas strut in the open position
- Luxurious sprung bedding and backrests finished in fire retardant fabric and a superior sprung mattress in the 545/4 and the 560/4
- Luxurious floor covering with luxury loose-lay carpets
- **NEW** contemporary Ash interior design incorporating bespoke moulded units
- **NEW** furniture doors with double metallic trim and **NEW** door and drawer handles
- **NEW** pull-out top on the 3-drawer chest of drawers
- Metal runners on all drawers
- Domestic style bathroom door in the 460/2, 470/2, 520/4 and the 560/4
- **NEW** re-designed end-bathroom with round domestic quality shower cubicles in the 460/2 and the 520/4
- **NEW** Belfast sinks in all end-bathroom models
- **NEW** kitchen workstation with Spinflo Argent recessed stainless steel sink and drainer, glass lid, plastic bowl and food grade chopping board with improved work surface and storage areas
- Cocktail cabinet in all models

### Equipment

- AL-KO ATC system (active trailer control)
- Remote control alarm system with PIR and tilt sensors for added security (Key fob also controls the awning light)
- Pioneer CD/MP3 player with iPod/MP3 connection, fully wired for optional DVD playback
- Thetford Aspire oven with **NEW** dual fuel hob and grill with electronic ignition and flame failure
- Microwave oven in dedicated housing
- Thetford 107 litre refrigerator with 11 litre freezer, electronic ignition, digital display and stylish curved stainless finish door with black trim
- **NEW** and **EXCLUSIVE** Truma Combi-boiler with programmable timing system for heating and hot water
- Truma awning warmer
- Truma Ultraflow water system with combined pressure switch/surge damper and filter
- Electric flush Thetford C260 cassette toilet with pump filler
- **NEW** Omnivent rooflight extractor fan with clear dome
- External BBQ gas point
- Truma gas regulator hose

### Electrical System

- 13 pin Jaeger plug
- **NEW** design easy-access power centre
- BCA dual stage power centre with 20 amp power supply for caravan 12 volt requirements and separate battery conditioning charger
- **NEW** digital 12 volt control panel
- **NEW** direct and indirect LED lighting throughout the whole caravan
- 12 volt LED reading lights
- Exterior TV aerial input socket
- Exterior satellite input socket
- **NEW** solar panel connection
- Status 530 swivel directional TV aerial

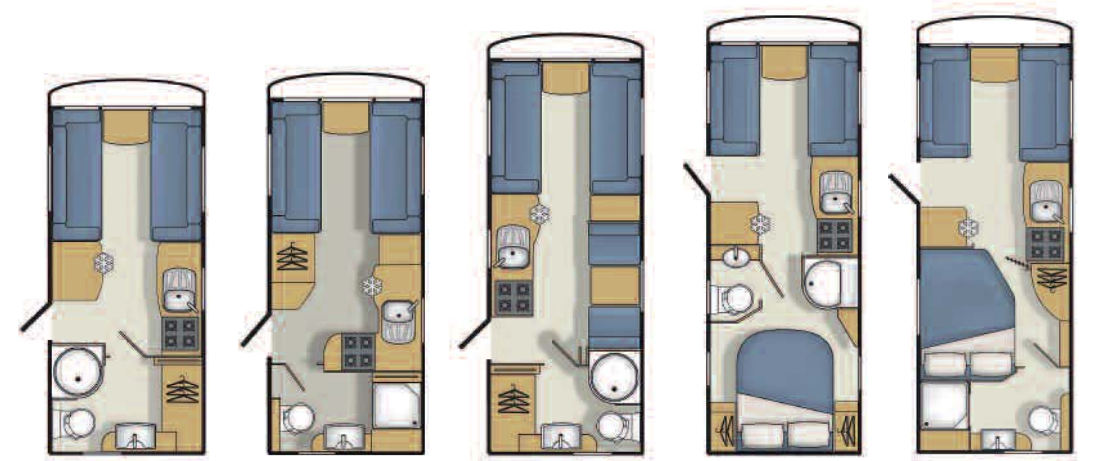

PASTICHE 460/2

PASTICHE 470/2

PASTICHE 520/4

PASTICHE 545/4

PASTICHE 560/4





### *The Amara – Designed with families in mind*

For families who want more from their holidays...

The 2012 Amara is the culmination of years of development and the product of our quest to create the perfect family tourer. It's become one of our most popular ranges, and as soon as you step inside you'll understand why.

Offering industry-leading build quality, exceptional style and excellent value for money, the Amara is all the caravan you will ever need to make the most of your leisure time.

Comfortable, well equipped and versatile, the Amara is perfect for new caravanners and seasoned tourers alike. With eight flexible layouts to choose from ranging from two to six berth configurations, there's sure to be an Amara model to suit every family and budget.





### 2012 Amara features and benefits:

Customers loved the multi-award winning 2011 Amara, and this year, we've made it even better. Using advanced new materials in the construction, the Amara is lighter and stronger than ever, so you don't need a 4x4 to tow many of the models.

The Amaras make effective use of every inch of space and there are configurations available with separate areas designed for children, which can be closed off. With lift-up bed bike storage, a Pioneer entertainment centre for rainy days, and a host of innovative new features, the 2012 Amara has something for everyone.

We know you want value for money when investing in a caravan, and with the Amara, you don't have to compromise on quality. Every caravan is hand-built by experienced teams to exacting standards. It's the Coachman way.







### External Features

- Grade 3 thermal insulation
- Aluminium sides manufactured from thicker aluminium for greater impact resistance
- Provision for the AL-KO Secure wheel clamping system
- Shock absorbers
- Vortex graphite shadow alloy wheels (steel spare wheel)
- **NEW** style AKS stabiliser
- Wide body shell with overall width of 7' 5"
- Acrylic capped front ABS panel incorporating three opening windows, integral grab handles, and gas bottle locker door with gas strut
- Full height acrylic capped rear ABS panel with high level LED brake light and new light cluster incorporating fog light and reversing light
- Laminated roof
- 45mm thick floor with Styrofoam core for insulation and strength
- LED awning light incorporating rain gutter
- **NEW** double sealed Hartal one-piece exterior door with waste bucket
- Full length door flyscreen
- Lined external locker with 230 volt socket (not in the 560/4)
- Stabilform heavy duty rear corner steadies on the twin axle models – 640/6 and the 655/6

### Internal Features

- Headroom 6' 5"
- Fully engineered aluminium frame front beds with hinged lift-up system supported by a gas strut in the open position
- **NEW** luxurious sprung bedding and backrests finished in fire retardant fabric with a superior sprung mattress in the 560/4
- Luxurious floor covering with luxury loose-lay carpets
- Italian two-tone locker doors with metallic trim
- Ash design on all internal furniture
- **NEW** pull-out top to the 3-drawer chest of drawers
- Metal runners on all drawers

- Domestic style bathroom door in the 450/2, 520/4, 560/4 and the 640/6
- All shower cubicles have ABS shower trays
- ABS bathroom basins
- Venetian blind in the bathroom of the end-bathroom models
- Kitchen workstation with Spinflo Argent recessed stainless steel sink and drainer, glass lid, plastic bowl and food grade chopping board
- Heki 2 panoramic rooflight in all models
- Soft-close flyscreens and blinds to all windows

### Equipment

- Pioneer CD/MP3 player with iPod /MP3 connection, fully wired for optional DVD playback
- Stainless steel Caprice oven with **NEW** dual fuel hob and grill, both with electronic ignition and flame failure
- Microwave oven in dedicated housing
- Thetford 107 litre refrigerator with 11 litre freezer, electronic ignition, digital display and stylish curved stainless finish door with black trim
- Truma 3002 space heater (3.4 kw) with Truma Ultraheat blown air central heating (gas and electric)
- Truma Ultraflow water system with double element for speedier performance with combined pressure switch/surge damper and filter
- Electric flush Thetford C260 cassette toilet with pump filler
- **NEW** Omnivent rooflight extractor fan with clear dome
- External BBQ gas point
- Truma gas regulator hose

### Electrical System

- 13 pin Jaeger plug
- BCA 12 volt system (20amp) with battery charger
- Control panel with built-in voltmeter, voltmeter switch, awning light switch, water pump switch, 12 volt light switch and master switch
- 12 volt LED corner lighting system
- Ceiling lights with Halogen bulbs
- 12 volt LED reading lights
- Exterior TV aerial input socket
- Exterior satellite input socket
- Status 530 swivel directional TV aerial
- Provision for fitment of the AL-KO ATC system (active trailer control)
- External mains socket

